



**3 Bed
House - End Terrace
located in**

Offers over £140,000



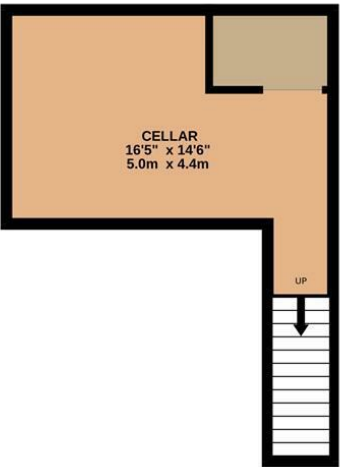

BURROWS
Residential

BASEMENT
216 sq.ft. (20.0 sq.m.) approx.

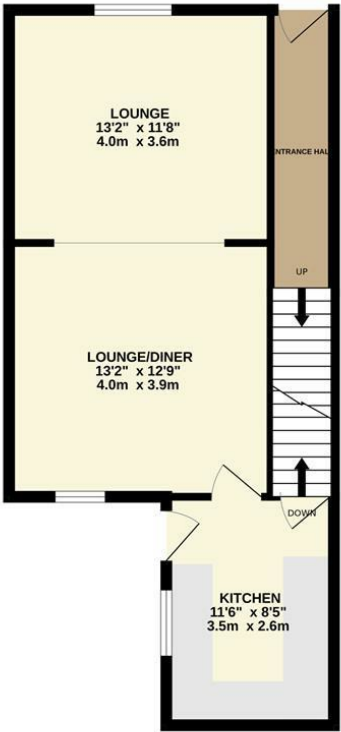

GROUND FLOOR
496 sq.ft. (46.0 sq.m.) approx.



1ST FLOOR
492 sq.ft. (45.7 sq.m.) approx.



TOTAL FLOOR AREA : 1203 sq.ft. (111.7 sq.m.) approx.

Whilst every attempt has been made to ensure the accuracy of the floorplan contained here, measurements of doors, windows, rooms and any other items are approximate and no responsibility is taken for any error, omission or mis-statement. This plan is for illustrative purposes only and should be used as such by any prospective purchaser. The services, systems and appliances shown have not been tested and no guarantee as to their operability or efficiency can be given.
Made with Metropix ©2025

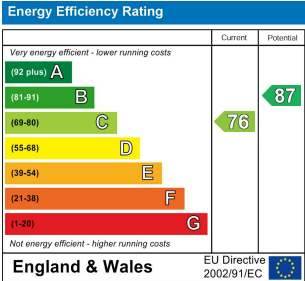

DIRECTIONS

CONTACT

Unit 6
Century 2 Business Centre 3 Dearne Lane
Manvers
Rotherham
E: info@burrowsresidential.co.uk
T: 07507 905644



BURROWS
Residential